

VIRGINIA
Living
museum



MUSEUM VISIT GUIDE

HIGH SCHOOL



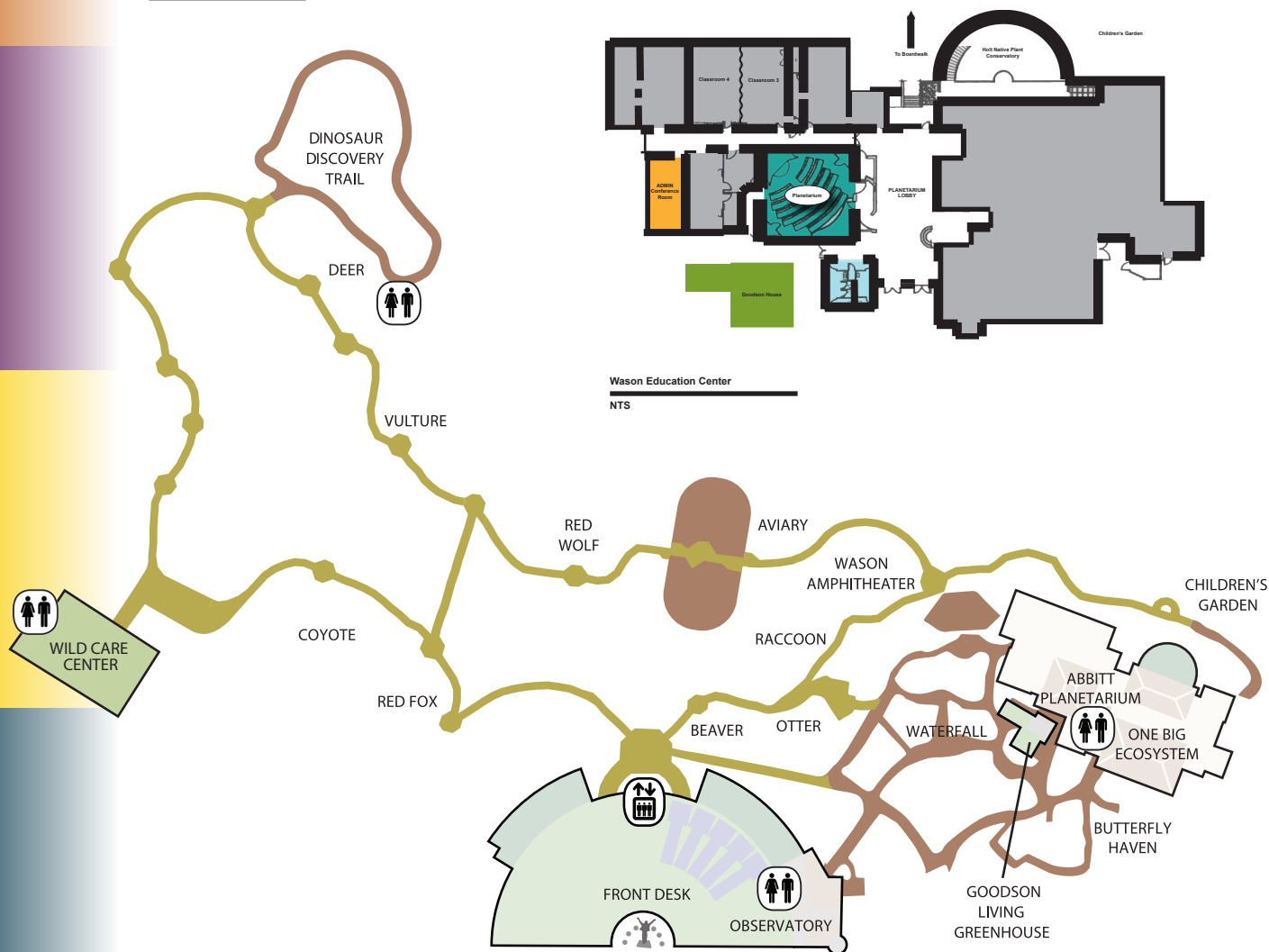
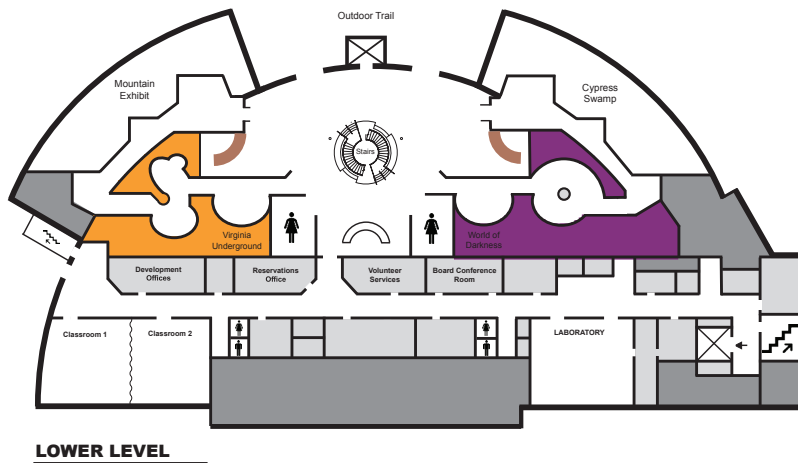
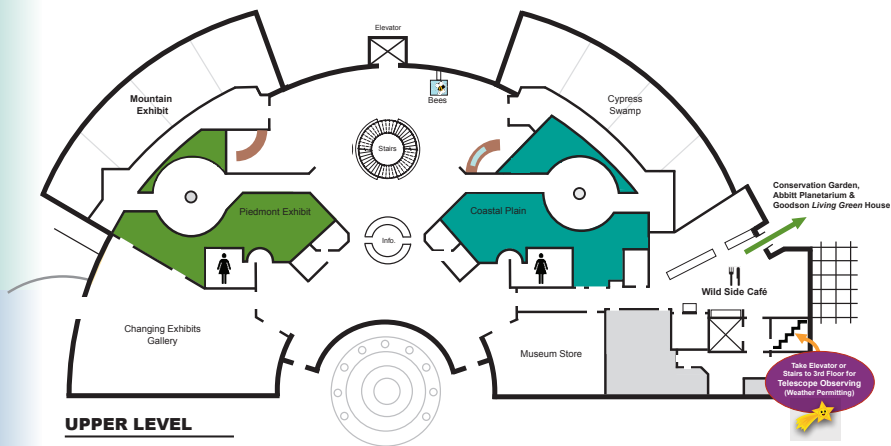

Please review the following guidelines with your students and chaperones prior to your visit:

Museum Guidelines

- Respect others in your group and other museum visitors.
- Use indoor voices.
- Walk in the museum.
- No food or drink outside of designated picnic areas.
- Students are not permitted to carry backpacks/large bags in the museum.
- Teachers and chaperones MUST stay with their groups at all times.
- For the safety and enjoyment of all visitors, disruptive or unsafe behavior will not be permitted and may result in the entire group being asked to leave without a refund.

Respect the Animals

- Do not yell at the animals on the outdoor trail. This includes howling at our coyotes and wolves.
- Do not attempt to touch or feed any animal.
- Do not bang or tap on the aquarium glass.
- If an animal is touched at the Touch Pool, please wash hands or use hand sanitizer.
- Do not climb on exhibits.
- Keep hands out of the aquarium water.

We've listed some suggested activities to conduct with your students before and after your visit.

Pre-Visit Questions

- What makes places like the Virginia Living Museum important to visit? How do you think they are helping conservation efforts?
- What kinds of things do zookeepers need to consider when caring for animals?

Post-Visit Questions

- Think about how you viewed the biodiversity of Virginia before visiting. Has that view changed at all after visiting the museum? Were you surprised by certain organisms that live here?
- Have you considered any other needs of animals after visiting the museum that you hadn't before?



Use the following guided questions to engage your students throughout the museum.

Coastal Plains Gallery:

- (LS.9, BIO.8) How would it impact the area if the Chesapeake Bay suddenly became inhabitable?

Piedmont & Mountains Gallery:

- (LS.9, BIO.8) What are some things that are impacting the spotted turtle population?

World of Darkness:

- (ES.10) What are three things the isopods may need to adapt to in the deep sea?

Cypress Swamp Gallery:

- (ES.8) Streams in Virginia are impacted by every day human activity. What are some things humans do that impact these streams?

VA Underground:

- (ES.5) Various rocks and minerals can be found in Virginia caverns. What are some differences and similarities between rocks and minerals?

Outdoor Trail:

- (BIO.8) On our outdoor trail we have multiple exhibits with more than one animal. What would happen if we added 10 more animals into an exhibit? How does this differ from what happens in the wild?

Outdoor Trail:

- (LS.9, BIO.8) Why are coyotes considered to be a “nuisance species”?

Wild Care Center:

- (BIOL.7) Imagine that all of the sudden our area became very cold and was covered in snow. What is one adaptation that may lead a skunk to survive better?



ANSWER KEY:

Coastal Plains Gallery:

- How would it impact the area if the Chesapeake Bay suddenly became inhabitable? *Answers may vary. Animals would start to die off/possibly go extinct, food sources would deplete, animals and people would have to move someplace else. Eventually it will start to spread to other areas of the country.*

Piedmont & Mountains Gallery:

- What are some things that are impacting the spotted turtle population? *Answers may vary. Habitat loss, water pollution, pet trade.*

World of Darkness:

- What are three things the isopods may need to adapt to in the deep sea? *Answers may vary. Adapting to pressure, poor eyesight, food adapting to low food availability.*

Cypress Swamp Gallery:

- Streams in Virginia are impacted by every day human activity. What are some things humans do that impact these streams? *Answers may vary. Littering, emitting fossil fuels, spilling any harmful chemicals.*

VA Underground:

- Various rocks and minerals can be found in Virginia caverns. What are some differences and similarities between rocks and minerals? *Rocks are naturally occurring, inorganic matter that does not have a uniform composition, has various chemicals throughout, and an unique crystal pattern. While minerals are naturally occurring, inorganic matter that looks the same throughout, has the same chemicals throughout, and a repeated crystal pattern.*

Outdoor Trail:

- On our outdoor trail we have multiple exhibits with more than one animal. What would happen if we added 10 more animals into an exhibit? How does this differ from what happens in the wild? *If more animals were added to the exhibit they may compete for resources such as space. However, because we provide our animals with food and water, they would likely not reach carrying capacity. However, in the wild, they may reach carrying capacity if the competition for resources is too great.*

Outdoor Trail:

- Why are coyotes considered to be a “nuisance species”? *They are known to occasionally feed on farmers’ livestock.*

Wild Care Center:

- (BIOL.7) Imagine that all of the sudden our area became very cold and was covered in snow. What is one adaptation that may lead a skunk to survive better? *Longer hibernation, all white coloration for camouflage, answers may vary.*

